



**£335,000** Fixed Price

Arbour Square, London, E1

Apartment | 1 Bedroom | 1 Bathroom



020 3925 0743

[www.thepropertyclub.london](http://www.thepropertyclub.london)





# Step Inside

---

## Key Features

- Ensuite Bathroom
- Sash Windows
- Wooden Floors
- Period conversion
- Patio
- Victorian Conversion
- Historical Georgian Square
- Maintained public garden enclosure first laid out in 1819

## Property Description

A Beautifully presented and newly refurbished one double bedroom apartment within a charming period conversion located in the very sought after Arbour Square.

## Main Particulars

Ideally located just off Commercial Road in the beautifully maintained Arbour Square, the location offers frequent busses, Shadwell and Limehouse Overground & DLR stations are just a short walk away, also Aldgate East & Whitechapel station are a short bus ride away.

The apartment has wood floors throughout, sash windows, white washed walls, fully fitted kitchen, open plan lounge, a modern en-suite shower room and a sunny patio garden just off the bedroom.

Ideal as a buy to let or for who is looking to get onto the property ladder.





## Arbour Square, E1

Approximate Gross Internal Area

383.73 sq ft / 31.65 sq m

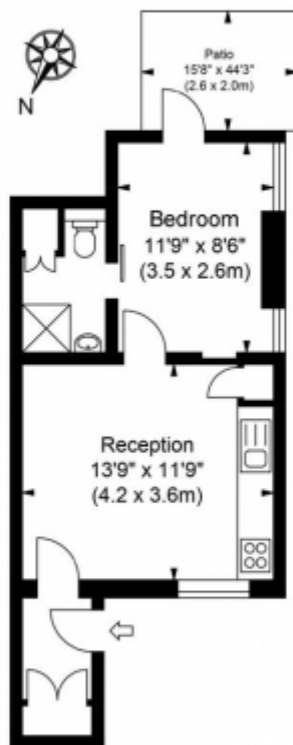

ILLUSTRATION FOR IDENTIFICATION PURPOSES ONLY

ALL MEASUREMENTS ARE MAXIMUM, AND INCLUDE WINDOW BAYS AND WARDROBES WHERE APPLICABLE  
THIS PLAN MUST NOT BE REPRODUCED BY ANY OTHER PERSON WITHOUT PERMISSION

This floorplan is for illustrative purposes only and the location of doors, windows and other items are approximate.

Telephone: 020 3925 0743



[www.thepropertyclub.london](http://www.thepropertyclub.london)